

**CSF COMPUTER EXCHANGE 5 (CX5)**



**Facility Overview**

CSF is expected to start the ground works for another Computer Exchange by 3<sup>rd</sup> Quarter of 2010. This facility will have 3 blocks of 5 storey data centres and a Class A office block incorporated with green building features. It will also be a carrier-neutral high end purpose built data centre.

<b>Location</b>	<b>Cyberjaya, Malaysia</b>
<b>Gross floor area</b>	<b>Approximately 550,000 ft<sup>2</sup></b>
<b>Net Data Center floor area</b>	<b>Approximately 200,000 ft<sup>2</sup></b>
<b>Raised floor load</b>	<b>15kN/m<sup>2</sup> in data centre area 15kN/m<sup>2</sup> at M&amp;E area</b>
<b>Raised floor</b>	<b>1m</b>
<b>Power density</b>	<b>30 W / ft<sup>2</sup> scalable up to 200 W / ft<sup>2</sup></b>
<b>Power feed</b>	<b>Dual 33kV incoming sources Dual on premise 33kV Power Substation</b>
<b>Electrical services</b>	<b>High Tension &amp; Low Voltage</b>
<b>Power back-up</b>	<b>Multiple back-up power generation</b>
<b>Uninterruptible Power Supply</b>	<b>N+1 or N+N option with 15 minutes battery reserve</b>
<b>Cooling system</b>	<b>Water-chilled and air-cooled systems</b>
<b>Fire suppression system</b>	<b>Water mist system in all data centre and common area. High Sensitivity Smoke Detection System Clean agent gas extinguishing system for the Power Substations.</b>
<b>Other</b>	<b>Data cabling and management Multiple Main Distribution Frame facilities Security access controls and intrusion alarms Water Detection System Dual Electrical Risers and Quadruple Data Risers</b>

For further enquiries, please contact our Cyberjaya sales team:

E-mail : [enquiry@csf-group.com](mailto:enquiry@csf-group.com)

Tel : +(6) 03 – 8318 1313 Fax : +(6) 03 – 8318 0303

**Ground Floor Plan Layout**

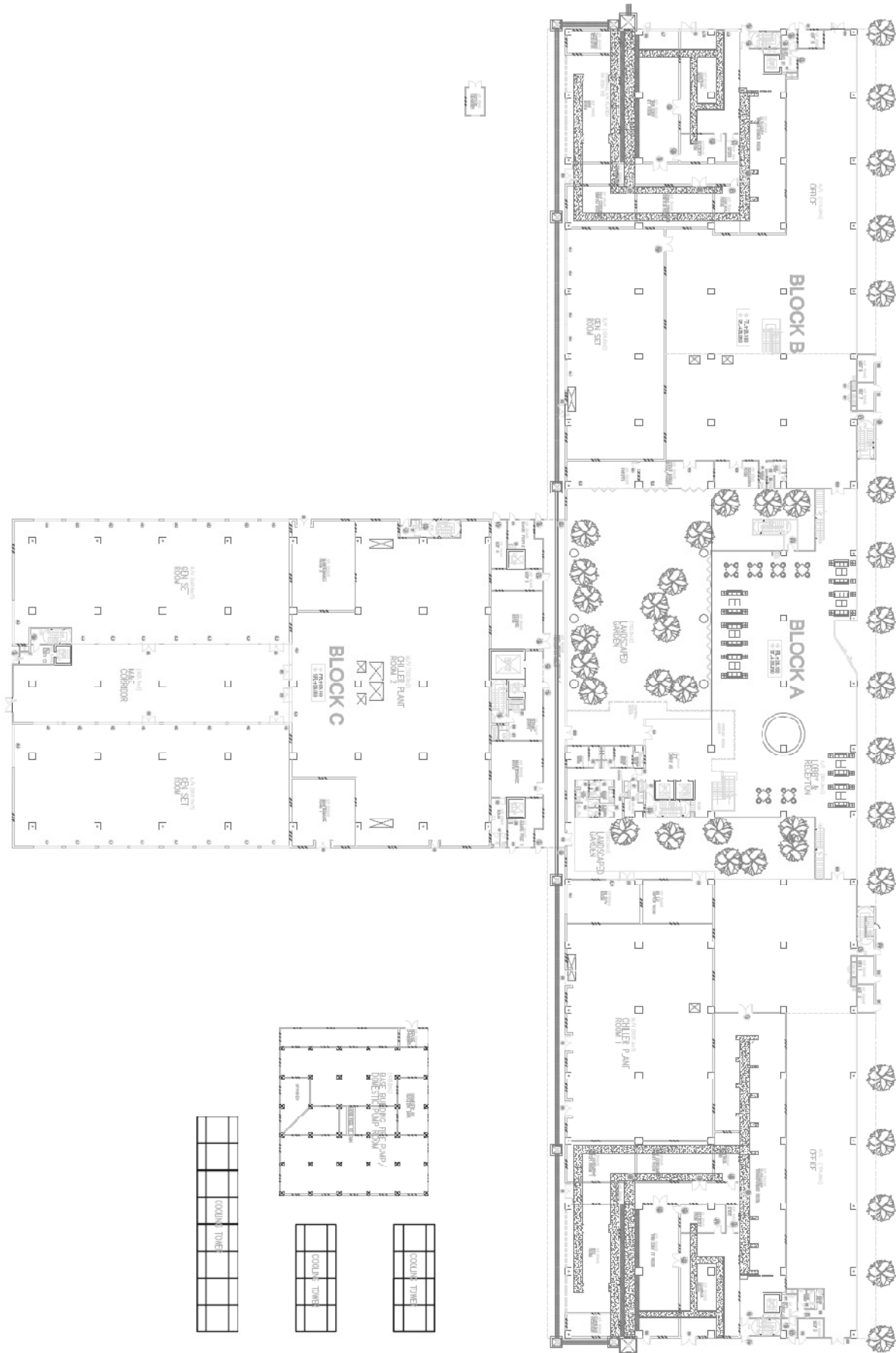

## Typical Floor Plan Layout

